

Following are simple steps for the installation of your Aqua View 45° Finder:

First: If your housing has a regular eyepiece installed already, it must be removed, remove the back of your housing and place on a clean and dry surface, on the inside locate the eye piece collar, and you should notice a rubber O-ring protruding from it. Remove the O-ring with either an O-ring tool or a dull pointed object, making sure not to cut it. Once the O-ring is removed, push the eyepiece out by pressing on it with both thumbs from the inside.

Remove the Retaining O-ring from the collar, flip the housing back cover so that you are facing the external part of it, inspect and apply a light coat of lubricant on the wall of the viewfinder sealing surface of the housing making sure it is clear of debris, inspect carefully the two remaining O-ring from the Aqua View Finder to insure they are clean and lubricate them, remember that a light coat is all that is needed, the O-ring does the sealing, not the lubricant. The user as the responsibility to make sure that all O-rings as well as the viewfinder are cleaned and properly installed.

Insert the Aqua View Finder by slightly rotating left and right. You will notice a small stainless steel alignment pin, there is a matched cut-out on the external collar of the Aqua View Finder, this pin should come to rest in that cut-out.

Finally flip the housing back cover over and reinstall the retaining O-ring on the Aqua View Finder internal collar. As always is the case when installing components such as ports, extension and viewfinder, the user should immerse the housing with out the camera to confirm that all was done properly

Warning: When traveling always remove the eyepiece from the housing and never lift or carry the housing using the Aqua View Finder as a handle. It is your responsibility to advice people handling your equipment accordingly. Treat your eyepiece with care and store in a padded container or lens bag.

Eye piece adjustment : It is possible to adjust The Aqua View Finder to one's eyesight, to adjust use the eyesight adjustment of your camera and rotate or slide until properly adjusted comfortably to your eye, to do this refer to the camera user manual, remember to use small increments.

When shooting vertical composed image with the housing, the viewfinder can be rotated to either side to make viewing and composing easier, to do so simply grab the body of the viewfinder and rotate it either clockwise or counterclockwise depending of your shooting preference

-----**WARNING**-----

*The Aqua View has no user serviceable internal part, dismantling or tampering your Aqua View Finder will void its warranty and may cause irreparable damages and/or flooding of the unit and its housing.*

## AQUATICA

3025 De Baene St., Montreal, Quebec, Canada, H4S 1K8  
Tel.: 514-737-9481 info@aquatica.ca Fax : 514-737-7685

# AQUATICA™

## Digital

### # 20059



Thank you for acquiring the Aqua View 45° Finder from Aquatica, the viewfinder optics are made from high quality coated glass elements and as such should be treated with the same respect as your camera lenses or any precision optical tool; the viewfinder external casing is machined from aircraft quality aluminium and anodized for protection again salt water corrosion.

Your Aqua View 45° Finder is supplied with a Soft carrying pouch and a protective cap.

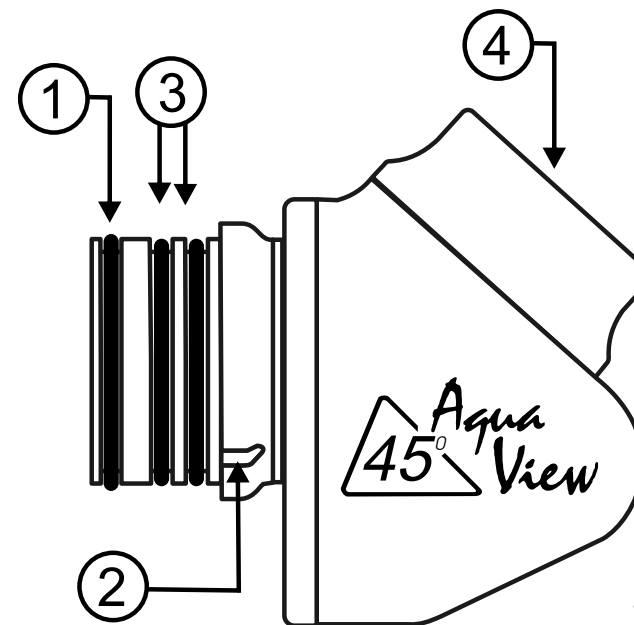

- 1: Retaining O-ring
- 2: Allignement pin slot
- 3: Sealing O-rings (x2)
- 4: View finder eye piece

# AQUA VIEW COMPATIBILITY

## HOUSINGS FOR:

CANON 1Dc & 1Dx YES

CANON 1DS Mk III & 1D Mk IV YES

CANON 5DS & 5Dsr YES

CANON 5D Mk III YES

CANON 5D Mk II YES

CANON 5D \*YES

CANON 7D Mk II YES

CANON 7D YES

CANON 70D YES

CANON 40D & 50D YES

CANON 30D YES

CANON 20D NO

CANON T2i/550D YES

CANON DIGITAL REBEL / 300D NO

## HOUSING FOR :

Panasonic DMC-GH4 YES

Olympus OM-D E-M1 NO

## HOUSINGS FOR:

Nikon D4, D4s YES

Nikon D3, D3S & D3X YES

Nikon D2x, D2xs & D2H YES

Nikon D810 YES

Nikon D800 YES

Nikon D700 YES

Nikon D600 & D610 YES

Nikon D300s YES

Nikon D300 YES

Nikon D200 & Fuji S2 Pro YES

Nikon D7100 & 7200 YES

Nikon D7000 YES

Nikon D40, D40x & D60 YES

Nikon D90 YES

Nikon D80 YES

Nikon D70 & D70s \*YES

Nikon D100 NO

# AQUATICA™ Digital



All current Aquatica housings for DSLR, manufactured after 2004, are compatible with the Aqua View Finders.

\* Some pre 2004 housing were compatible. in order for a housing to be compatible, it should have a removable eye piece retained with an O-ring. (see image below)

