



# AQUATICA™

## Digital

Thank you for acquiring the Aqua View 45° Finder from Aquatica (# 20059), the viewfinder optics are made from high quality coated glass elements and as such should be treated with the same respect as your camera lenses or any precision optical tool; the viewfinder external casing is machined from aircraft quality aluminium and anodized for protection against salt water corrosion.

Your Aqua View 45° Finder is supplied with the following : One Soft carrying pouch and a protective cap.

### Following are simple steps for the installation of your Aqua View 45° Finder:

First: If your housing has a regular eyepiece installed already, it must be removed, remove the back of your housing and place on a clean and dry surface, on the inside locate the eye piece collar, and you should notice a rubber O-ring protruding from it. Remove the O-ring with either an O-ring tool or a dull pointed object, making sure not to cut it. Once the O-ring is removed, push the eyepiece out by pressing on it with both thumbs from the inside.

Remove the Retaining O-ring from the collar, flip the housing back cover so that you are facing the external part of it, inspect and apply a light coat of lubricant on the wall of the viewfinder sealing surface of the housing making sure it is clear of debris, inspect carefully the two remaining O-ring from the Aqua View Finder to insure they are clean and lubricate them, remember that a light coat is all that is needed, the O-ring does the sealing, not the lubricant. The user assumes the responsibility to make sure that all O-rings as well as the viewfinder are cleaned and properly installed.

Insert the Aqua View Finder by slightly rotating left and right. You will notice a small stainless steel alignment pin, there is a matched cut-out on the external collar of the Aqua View Finder, this pin should come to rest in that cut-out.

Finally flip the housing back cover over and reinstall the retaining O-ring on the Aqua View Finder internal collar. As always is the case when installing components such as ports, extension and viewfinder, the user should immerse the housing with out the camera to confirm that all was done properly

**Warning:** When traveling always remove the eyepiece from the housing and never lift or carry the housing using the Aqua View Finder as a handle. It is your responsibility to advise people handling your equipment accordingly. Treat your eyepiece with care and store in a padded container or lens bag.

Eye piece adjustment : It is possible to adjust The Aqua View Finder to one's eyesight, to adjust use the eyesight adjustment of your camera and rotate or slide until properly adjusted comfortably to your eye, to do this refer to the camera user manual, remember to use small increments.

When shooting vertical composed image with the housing, the viewfinder can be rotated to either side to make viewing and composing easier, to do so simply grab the body of the viewfinder and rotate it either clockwise or counterclockwise depending of your shooting preference

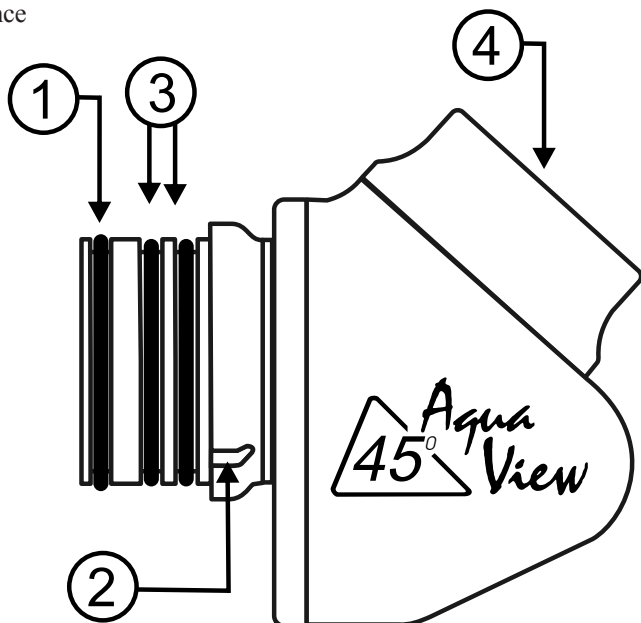

- 1: Retaining O-ring
- 2: Allignement pin slot
- 3: Sealing O-rings (x2)
- 4: View finder eye piece

-----**WARNING**-----  
*The Aqua View has no user serviceable internal part, dismantling or tampering your Aqua View Finder will void its warranty and may cause irreparable damages and/or flooding of the unit and its housing.*

## AQUATICA

3025 De Baene St., Montreal, Quebec, Canada, H4S 1K8  
Tel.: 514-737-9481 info@aquatica.ca Fax : 514-737-7685